



Equal Elbow Couplings - EE

(BAR-STOCK)

ISO fittings

Metric Tube end as per ISO 8434

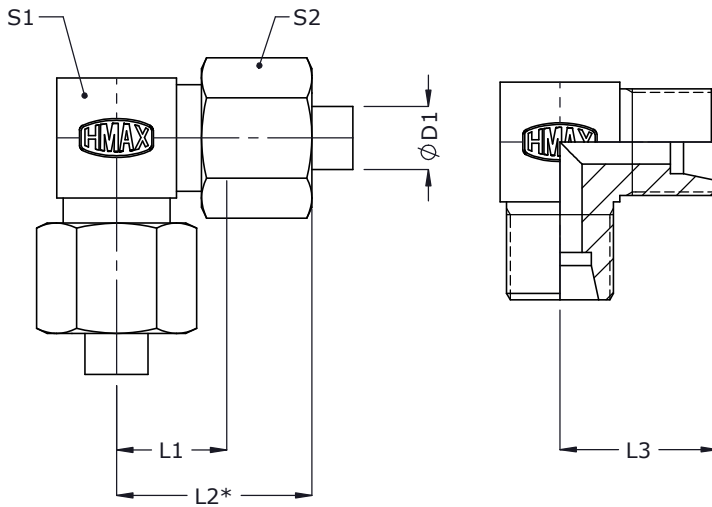

2D Assembly

2D Body

Series	Tube od Ø D1	L1	L2*	L3	S1	S2	Assembly		Body
							Part code	Item no_	Item no_
Light (L) 250 bar	6	12.0	27.5	19.0	12	14	EE6L-F	24	1217
	8	14.0	29.0	21.0	14	17	EE8L-F	25	1218
	10	15.0	30.5	22.0	17	19	EE10L-F	26	1219
	12	17.0	32.0	24.0	19	22	EE12L-F	27	1220
	15	21.0	37.0	28.0	22	27	EE15L-F	28	1221
160 bar	18	23.5	40.5	31.0	27	32	EE18L-F	29	1222
	22	27.5	44.5	35.0	30	36	EE22L-F	30	1223
100 bar	28	30.5	48.5	38.0	36	41	EE28L-F	31	1224
	35	34.5	57.5	45.0	46	50	EE35L-F	32	1225
	42	40.0	63.5	51.0	55	60	EE42L-F	33	1226
Heavy (S) 630 bar	6	16.0	31.5	23.0	14	17	EE6S-F	34	1227
	8	17.0	32.0	24.0	17	19	EE8S-F	35	1228
	10	17.5	34.5	25.0	19	22	EE10S-F	36	1229
	12	21.5	38.0	29.0	22	24	EE12S-F	37	1230
400 bar	16	24.5	43.5	33.0	24	30	EE16S-F	38	1231
	20	26.5	49.0	37.0	30	36	EE20S-F	39	1232
	25	30.0	55.0	42.0	36	46	EE25S-F	40	1233
250 bar	30	35.5	63.5	49.0	46	50	EE30S-F	41	1234
	38	41.0	72.5	57.0	55	60	EE38S-F	42	1235

* Dimensions given are approx figures with tightened nut.



Equal Elbow Couplings - EE

(FORGED)

ISO fittings

Metric Tube end as per ISO 8434

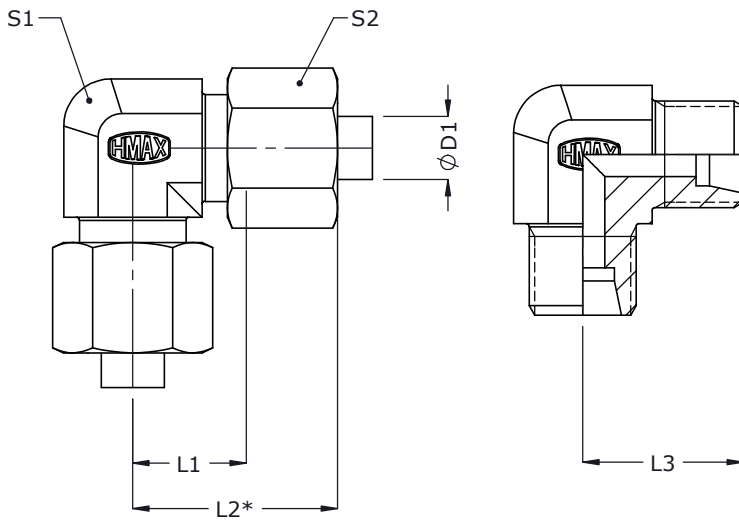

2D Assembly

2D Body



Series	Tube od ØD1	L1	L2*	L3	S1	S2	Assembly		Body
							Part code	Item no_	Item no_
Light (L) 250 bar	6	12.0	27.5	19.0	12	14	EE6L	43	32
	8	14.0	29.0	21.0	14	17	EE8L	44	33
	10	15.0	30.5	22.0	17	19	EE10L	45	34
	12	17.0	32.0	24.0	19	22	EE12L	46	35
	15	21.0	37.0	28.0	22	27	EE15L	47	36
160 bar	18	23.5	40.5	31.0	27	32	EE18L	48	37
	22	27.5	44.5	35.0	30	36	EE22L	49	38
100 bar	28	30.5	48.5	38.0	36	41	EE28L	50	39
	35	34.5	57.5	45.0	46	50	EE35L	51	40
	42	40.0	63.5	51.0	55	60	EE42L	52	41
Heavy (S) 630 bar	6	16.0	31.5	23.0	14	17	EE6S	53	22
	8	17.0	32.0	24.0	17	19	EE8S	54	23
	10	17.5	34.5	25.0	19	22	EE10S	55	24
	12	21.5	38.0	29.0	22	24	EE12S	56	25
400 bar	16	24.5	43.5	33.0	24	30	EE16S	57	27
	20	26.5	49.0	37.0	30	36	EE20S	58	28
	25	30.0	55.0	42.0	36	46	EE25S	59	29
250 bar	30	35.5	63.5	49.0	46	50	EE30S	60	30
	38	41.0	72.5	57.0	55	60	EE38S	61	31

* Dimensions given are approx figures with tightened nut.