

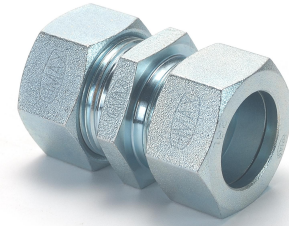

Straight Couplings - SC

ISO fittings

Metric Tube end as per ISO 8434

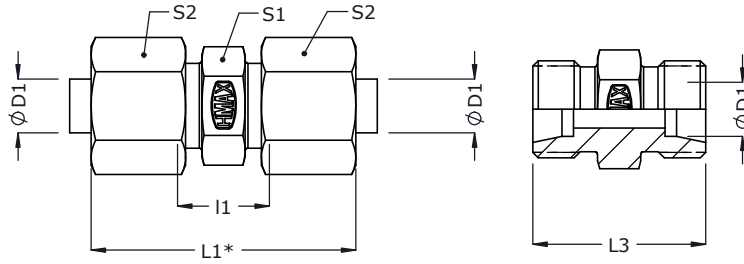

2D Assembly

2D Body

Series	Tube od ϕ D1	I1	L1*	L3	S1	S2	Assembly		Body
							Part code	Item no_	Item no_
Light Low(LL) 100 bar	4	12	31	20	9	10	SC4LL	01	960
	5	10	33	21	11	12	SC5LL	02	961
	6	12	35	23	11	12	SC6LL	03	962
	8	12	35	23	12	14	SC8LL	04	963
Light (L) 250 bar	6	10	41	24	12	14	SC6L	05	012
	8	11	41	25	14	17	SC8L	06	013
	10	13	44	27	17	19	SC10L	07	014
	12	14	44	28	19	22	SC12L	08	015
	15	16	48	30	24	27	SC15L	09	016
160 bar	18	16	50	31	27	32	SC18L	10	017
	22	20	54	35	32	36	SC22L	11	018
100 bar	28	21	57	36	41	41	SC28L	12	019
	35	20	66	41	50	50	SC35L	13	020
	42	21	68	43	50	60	SC42L	14	021
Heavy (S) 630 bar	6	16	47	30	14	17	SC06S	15	001
	8	18	48	32	17	19	SC08S	16	002
	10	17	51	32	19	22	SC10S	17	003
	12	19	52	34	22	24	SC12S	18	004
400 bar	16	21	59	38	27	30	SC16S	19	006
	20	23	68	44	32	36	SC20S	20	007
	25	26	76	50	41	46	SC25S	21	008
250 bar	30	27	83	54	46	50	SC30S	22	009
	38	29	92	61	55	60	SC38S	23	010

* Dimensions given are approx figures with tightened nut.