



Equal Cross Couplings - EC

(BAR-STOCK)

ISO fittings

Metric Tube end as per ISO 8434

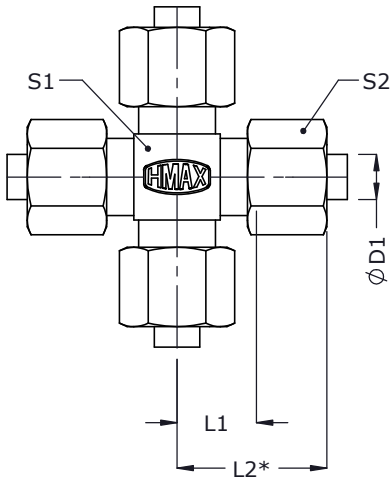

2D Assembly

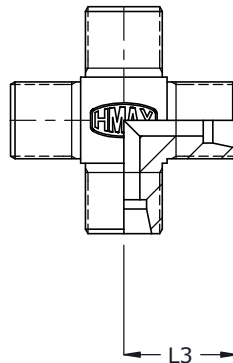

2D Body



Series	Tube od ØD1	L1	L2*	L3	S1	S2	Assembly		Body
							Part code	Item no_	Item no_
Light (L) 250 bar	6	12.0	27.5	19.0	12	14	EC6L-F	111	1255
	8	14.0	29.0	21.0	14	17	EC8L-F	112	1256
	10	15.0	30.5	22.0	17	19	EC10L-F	113	1257
	12	17.0	32.0	24.0	19	22	EC12L-F	114	1258
	15	21.0	37.0	28.0	22	27	EC15L-F	115	1259
160 bar	18	23.5	40.5	31.0	27	32	EC18L-F	116	993
	22	27.5	44.5	35.0	30	36	EC22L-F	117	1260
100 bar	28	30.5	48.5	38.0	36	41	EC28L-F	118	1261
	35	34.5	57.5	45.0	46	50	EC35L-F	119	1262
	42	40.0	63.5	51.0	55	60	EC42L-F	120	1263
Heavy (S) 630 bar	6	16.0	31.5	23.0	14	17	EC6S-F	121	1264
	8	17.0	32.0	24.0	17	19	EC8S-F	122	1265
	10	17.5	34.5	25.0	19	22	EC10S-F	123	1266
	12	21.5	38.0	29.0	22	24	EC12S-F	124	1267
400 bar	16	24.5	43.5	33.0	24	30	EC16S-F	125	1268
	20	26.5	49.0	37.0	30	36	EC20S-F	126	1269
	25	30.0	55.0	42.0	36	46	EC25S-F	127	1270
250 bar	30	35.5	63.5	49.0	46	50	EC30S-F	128	1271
	38	41.0	72.5	57.0	55	60	EC38S-F	129	1272

* Dimensions given are approx figures with tightened nut.