

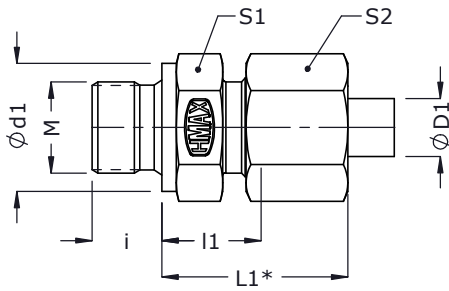

Straight Male Stud Couplings - MSC-M

ISO fittings

Metric Tube end as per ISO 8434
Male Metric (M) thread



2D Assembly

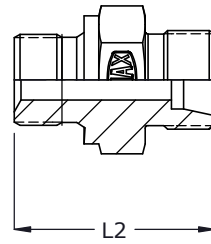

2D Body



Series	Tube od ØD1	M Male METRIC thread	Ød1	i	l1	L1*	L2	S1	S2	Assembly		Body
										Part code	Item no_	Item no_
Light (L) 315 bar	6	M10 x 1.0	14	8	8.5	24.0	23.5	14	14	MSC06LM10	267	1587
	8	M12 x 1.5	17	12	10.0	25.0	29.0	17	17	MSC08LM12	268	1588
	8	M18 x 1.5	23	12	11.5	26.5	30.5	24	17	MSC08LM18	269	1589
	10	M14 x 1.5	19	12	11.0	26.5	30.0	19	19	MSC10LM14	270	1590
	10	M16 x 1.5	21	12	12.0	27.5	31.0	22	19	MSC10LM16	271	1591
	10	M18 x 1.5	23	12	12.5	28.0	31.5	24	19	MSC10LM18	272	1592
	10	M22 x 1.5	27	14	14.0	29.5	35.0	27	19	MSC10LM22	273	1593
	12	M14 x 1.5	19	12	11.0	26.0	30.0	19	22	MSC12LM14	274	1594
	12	M16 x 1.5	21	12	12.5	27.5	31.5	22	22	MSC12LM16	275	1595
	12	M18 x 1.5	23	12	12.5	27.5	31.5	24	22	MSC12LM18	276	1596
	12	M22 x 1.5	27	14	14.0	29.0	35.0	27	22	MSC12LM22	277	1597
	15	M16 x 1.5	21	12	13.0	29.0	32.0	24	27	MSC15LM16	278	1598
	15	M18 x 1.5	23	12	13.5	29.5	32.5	24	27	MSC15LM18	279	1599
	15	M22 x 1.5	27	14	15.0	31.0	36.0	27	27	MSC15LM22	280	1600
	160 bar	18	M18 x 1.5	23	12	14.0	31.0	33.5	27	32	MSC18LM18	281
18		M22 x 1.5	27	14	14.5	31.5	36.0	27	32	MSC18LM22	282	1602
22		M22 x 1.5	27	14	16.5	33.5	38.0	32	36	MSC22LM22	283	1603
22		M26 x 1.5	31	16	16.5	33.5	40.0	32	36	MSC22LM26	284	1604
28		M33 x 2.0	39	18	17.5	35.5	43.0	41	41	MSC28LM33	285	1605
Heavy (S) 630 bar	35	M42 x 2.0	49	20	17.5	40.5	48.0	50	50	MSC35LM42	286	1606
	42	M48 x 2.0	55	22	19.0	42.5	52.0	55	60	MSC42LM48	287	1607
	6	M12 x 1.5	17	12	13.0	28.5	32.0	17	17	MSC06SM12	288	1608
	8	M14 x 1.5	19	12	15.0	30.0	34.0	19	19	MSC08SM14	289	1609
	10	M16 x 1.5	21	12	15.0	32.0	34.5	22	22	MSC10SM16	290	1610
400 bar	12	M18 x 1.5	23	12	17.0	33.5	36.5	24	24	MSC12SM18	291	1611
	12	M22 x 1.5	27	14	17.5	34.0	39.0	27	24	MSC12SM22	292	1612
	16	M18 x 1.5	23	12	18.0	37.0	38.5	27	30	MSC16SM18	293	1613
	16	M22 x 1.5	27	14	18.5	37.5	41.0	27	30	MSC16SM22	294	1614
250 bar	20	M27 x 2.0	32	16	20.5	43.0	47.0	32	36	MSC20SM27	295	1615
	25	M33 x 2.0	39	18	23.0	48.0	53.0	41	46	MSC25SM33	296	519
	30	M42 x 2.0	49	20	23.5	51.5	57.0	50	50	MSC30SM42	297	1616
	38	M48 x 2.0	55	22	26.0	57.5	64.0	55	60	MSC38SM48	298	1617

* Dimensions given are approx figures with tightened nut.