

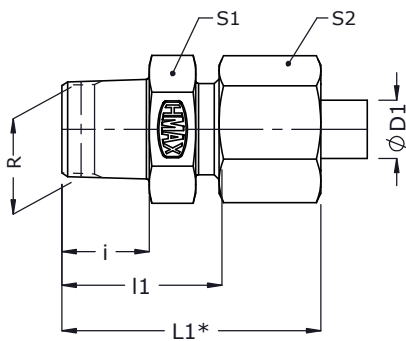

Straight Male Stud Couplings - MSC-R

ISO fittings

Metric Tube end as per ISO 8434
Male BSP Taper(R) stud end



2D Assembly

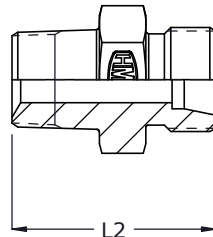

2D Body



Series	Tube od $\phi D1$	R Male BSPT thread	i	l1	L1*	L2	S1	S2	Assembly		Body
									Part code	Item no_	Item no_
Light (L) 250 bar	6	R 1/8	7.5	14.5	30.0	21.5	14	14	MSC6LR01	318	1637
	6	R 1/4	11.0	18.0	33.5	25.0	14	14	MSC6LR02	319	1638
	8	R 1/4	11.0	19.0	34.0	26.0	17	17	MSC8LR02	320	594
	10	R 1/4	11.0	20.0	35.5	27.0	17	19	MSC10LR02	321	1639
	12	R 1/4	11.0	20.0	35.0	27.0	19	22	MSC12LR02	322	1153
	12	R 3/8	11.5	20.5	35.5	27.5	19	22	MSC12LR03	323	1640
	12	R 1/2	15.0	25.0	40.0	32.0	22	22	MSC12LR04	324	1641
160 bar	15	R 1/2	15.0	26.0	42.0	33.0	24	27	MSC15LR04	325	1642
	18	R 1/2	15.0	26.5	43.5	34.0	27	32	MSC18LR04	326	1643
100 bar	22	R 3/4	16.5	30.0	47.0	37.5	32	36	MSC22LR06	327	1644
	28	R 1	19.0	33.5	51.5	41.0	41	41	MSC28LR08	328	1645
	35	R1 1/4	21.5	35.0	58.0	45.5	46	50	MSC35LR10	329	1646
Heavy (S) 630 bar	42	R1 1/2	21.5	37.5	61.0	48.5	55	60	MSC42LR12	330	1647
	6	R 1/4	11.0	22.0	37.5	29.0	17	17	MSC06SR02	331	1648
	8	R 1/4	11.0	22.0	37.0	29.0	17	19	MSC08SR02	332	1649
	10	R 1/4	11.0	23.5	40.5	31.0	19	22	MSC10SR02	333	1650
	10	R 3/8	11.5	24.0	41.0	31.5	19	22	MSC10SR03	334	1651
	12	R 1/4	11.0	25.5	42.0	33.0	22	24	MSC12SR02	335	1652
	12	R 3/8	11.5	26.0	42.5	33.5	22	24	MSC12SR03	336	1653
400 bar	12	R 1/2	15.0	29.5	46.0	37.0	22	24	MSC12SR04	337	62
	16	R 1/2	15.0	30.5	49.5	39.0	27	30	MSC16SR04	338	1654
	20	R 3/4	16.5	34.0	56.5	44.5	32	36	MSC20SR06	339	1655
250 bar	25	R 1	19.0	39.0	64.0	51.0	41	46	MSC25SR08	340	1656
	30	R1 1/4	21.5	42.0	70.0	55.5	46	50	MSC30SR10	341	1657
	38	R1 1/2	21.5	44.5	76.0	60.5	55	60	MSC38SR12	342	1658

* Dimensions given are approx figures with tightened nut.