

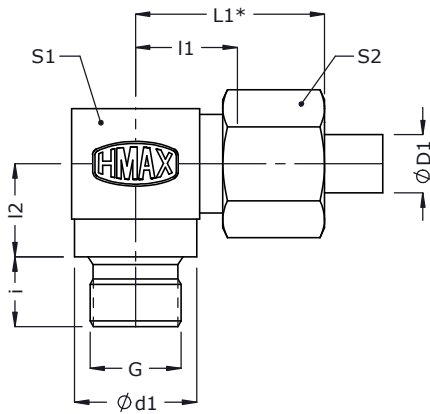

# Male Stud Elbow Couplings - MSE-G (BAR-STOCK)

Metric Tube end as per ISO 8434  
and BSPP(G) stud end

ISO fittings



2D Assembly

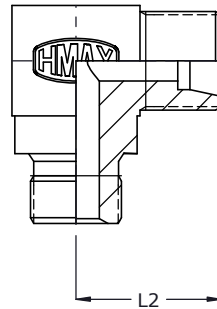

2D Body

Series	Tube od ØD1	G Male BSP thread	Ød1	i	l1	l2	L1*	L2	S1	S2	Assembly		Body
											Part code	Item no_	Item no_
<b>Light (L) 160 bar</b>	22	G 3/4 A	32	16	27.5	26	44.5	35	32	36	MSE22LG06-F	368	1794
	28	G 1 A	39	18	30.5	30	48.5	38	41	41	MSE28LG08-F	369	1795
	35	G1 1/4 A	49	20	34.5	34	57.5	45	50	50	MSE35LG10-F	370	1796
<b>100 bar</b>	42	G1 1/2 A	55	22	40.0	39	63.5	51	55	60	MSE42LG12-F	371	1797
<b>Heavy (S) 400 bar</b>	20	G 3/4 A	32	16	26.5	26	49.0	37	32	36	MSE20SG06-F	372	1798
	25	G 1 A	39	18	30.0	30	55.0	42	41	46	MSE25SG08-F	373	1799
	30	G1 1/4 A	49	20	35.5	34	63.5	49	50	50	MSE30SG10-F	374	1800
<b>250 bar</b>	38	G1 1/2 A	55	22	41.0	39	72.5	57	55	60	MSE38SG12-F	375	1801

\* Dimensions given are approx figures with tightened nut.



# Male Stud Elbow Couplings - MSE-G (FORGED)

Metric Tube end as per ISO 8434  
and BSPP(G) stud end

ISO fittings

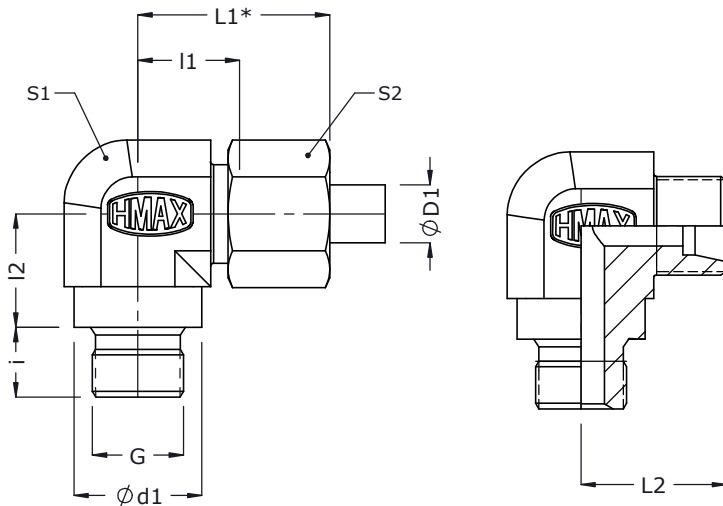

2D Assembly

2D Body

Series	Tube od D1	G Male BSP thread	Ød1	i	l1	l2	L1*	L2	S1	S2	Assembly		Body
											Part code	Item no_	Item no_
<b>Light (L) 160 bar</b>	22	G 3/4 A	32	16	27.5	26	44.5	35	32	36	MSE22LG06	414	1840
	28	G 1 A	39	18	30.5	30	48.5	38	41	41	MSE28LG08	415	1841
	35	G1 1/4 A	49	20	34.5	34	57.5	45	50	50	MSE35LG10	416	1842
<b>100 bar</b>	42	G1 1/2 A	55	22	40.0	39	63.5	51	55	60	MSE42LG12	417	1843
<b>Heavy (S) 400 bar</b>	20	G 3/4 A	32	16	26.5	26	49.0	37	32	36	MSE20SG06	418	1844
	25	G 1 A	39	18	30.0	30	55.0	42	41	46	MSE25SG08	419	1845
	30	G1 1/4 A	49	20	35.5	34	63.5	49	50	50	MSE30SG10	420	1846
<b>250 bar</b>	38	G1 1/2 A	55	22	41.0	39	72.5	57	55	60	MSE38SG12	421	1847

\* Dimensions given are approx figures with tightened nut.