

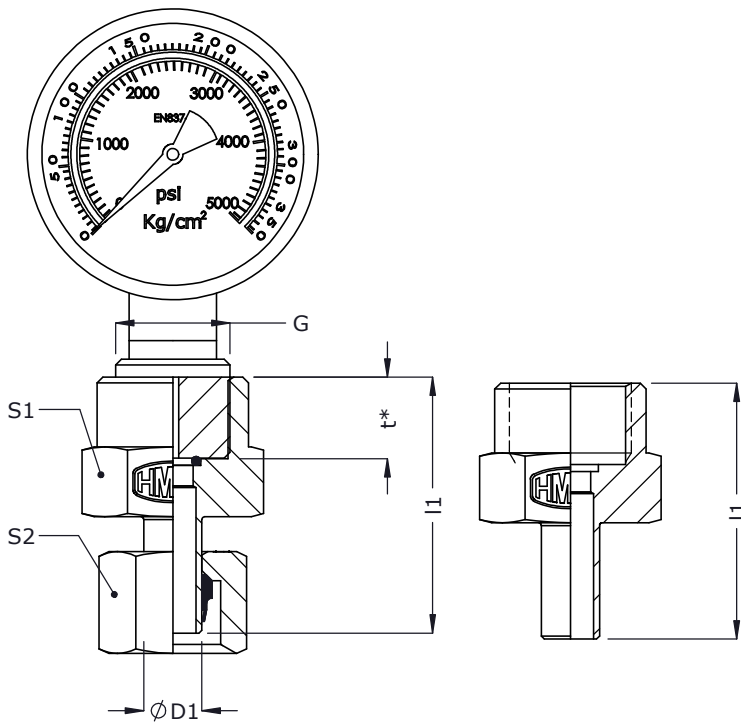

# Adjustable Pressure Gauge Standpipes - AGA

ISO fittings

For Metric Tube ends (24°) as per ISO 8434  
Gauge is not in scope of supply



2D Assembly

2D Body



Series	Tube od ØD1	Connection thread	l1	t1*	S1	S2	Assembly		Body
							Part code	Item no_	Item no_
<b>Light (L)</b> 250 bar	6	G 1/4 A	38.0	14.5	19	14	AGA6LG02	1161	2004
	8	G 1/4 A	38.0	14.5	19	17	AGA8LG02	1162	510
	10	G 1/4 A	39.5	14.5	19	19	AGA10LG02	1163	2005
	12	G 1/4 A	40.5	14.5	19	22	AGA12LG02	1164	2006
<b>250 bar</b>	6	G 3/8 A	38.0	16.5	22	14	AGA6LG03	1165	2007
	8	G 3/8 A	38.0	16.5	22	17	AGA8LG03	1166	2008
	10	G 3/8 A	39.5	16.5	22	19	AGA10LG03	1167	2009
	12	G 3/8 A	40.5	16.5	22	22	AGA12LG03	1168	2010
<b>Heavy (S)</b> 630 bar	6	G 3/8 A	41.0	16.5	22	17	AGA6SG03	1169	2011
	8	G 3/8 A	41.0	16.5	22	19	AGA8SG03	1170	2012
	10	G 3/8 A	43.0	16.5	22	22	AGA10SG03	1171	2013
	12	G 3/8 A	43.5	16.5	22	24	AGA12SG03	1172	2014
<b>630 bar</b>	6	G 1/2 A	45.0	20	27	17	AGA6SG04	1173	2015
	8	G 1/2 A	45.0	20	27	19	AGA8SG04	1174	2016
	10	G 1/2 A	47.0	20	27	22	AGA10SG04	1175	2017
	12	G 1/2 A	47.0	20	27	24	AGA12SG04	1176	2018

\* Dimensions given are approx figures with tightened nut.